

Instructions for clearing the JPEG2000 DVR hard drive

The first thing you need to know is how to identify the buttons on the DVR front panel

These are the buttons you will be using the most, MENU, ENTER, LEFT, RIGHT, UP, DOWN and the + (plus) and – (minus) buttons.

The symbol below each button designates what the button above it is for.

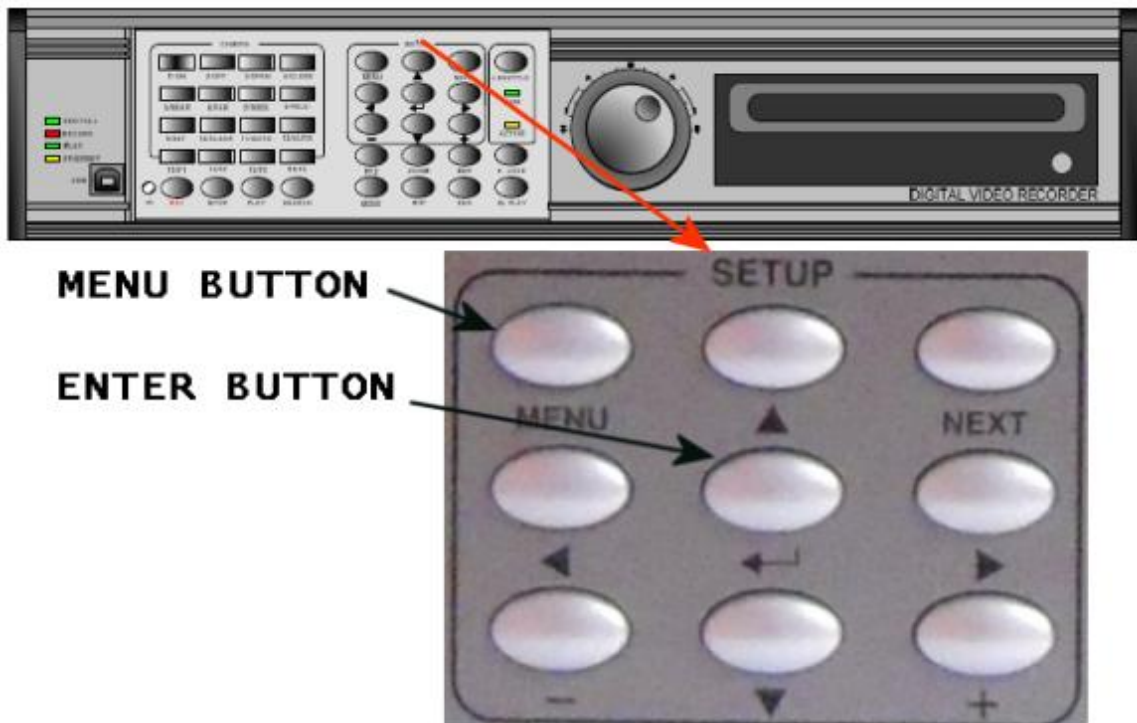

To clear the hard drive:

Press MENU the ENTER.

The DVR will ask for your password. By default there is no password so just press ENTER.
If you set a password then enter your password and then press ENTER.

You will now be in the SYSTEM MENU. Use the down arrow until the pointer is pointed at the CONFIGURATION option then press ENTER to enter the configuration menu.



You will now be in the CONFIGURATION menu. The pointer is already pointed at the HDD MANAGEMENT option so press ENTER to enter the HDD SETUP menu.



You will now be in the HDD SETUP menu. The pointer is already pointed at the HDD CLEAR option so press ENTER button. The DVR will ask for your password. By default there is no password so just press ENTER. If you set a password then enter your password and then press ENTER.

STATUS	HDD	DATE/TIME
BEGIN	MASTER	2005/04/08 12:12:05
RECORD	MASTER	2005/04/09 15:09:58
PLAY	MASTER	2005/04/08 19:44:31
HDD STATUS		NORMAL
HDD CLEAR		IN USE

HDD CLEAR [ENTER], EXIT [MENU]

The hard drives have now been cleared.

Keep pressing MENU until you are back at the main monitor-viewing screen and you are done.